

# Westminster Hall Basement

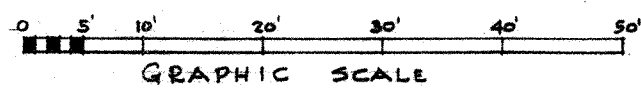
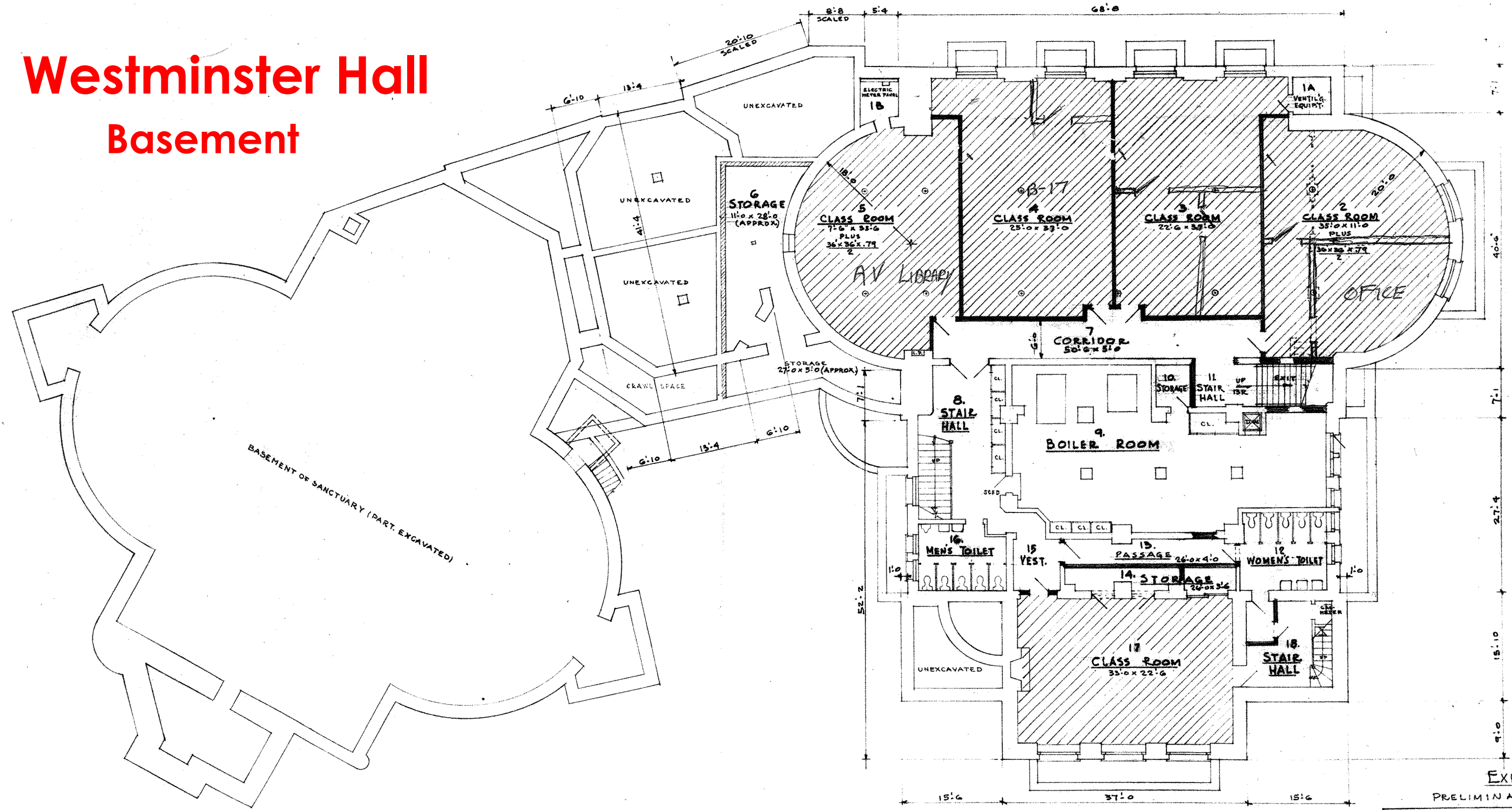

ASSIGNABLE AREA IN PROJECT  
 NONASSIGNABLE AREA

TOTAL BASEMENT ASSIGNABLE AREA = 4,146  
 " " NONASSIGNABLE " = 3,110

**EXHIBIT 3**  
PRELIMINARY

**BASEMENT**

ALTERATIONS TO  
WESTMINSTER BUILDING  
BLOOMFIELD COLLEGE  
FRANKLIN STREET BLOOMFIELD, N.J.

SCALE 1" = 10'-0"	STAAB & IMMEN ARCHITECTS THE ARCADE 555 BLOOMFIELD AVENUE GLEN RIDGE, N.J.	COMM. NO. <b>66.1</b>
DATE 3.1.66		SHEET NO. PREL. 1
OWN. D.		OF 3
CHKD. APPD.		LICENSE NO. C-2334 William A. Staab N.J. REG. ARCHITECT